

# PRODUCT DATA SHEET

## Muro Plus 500 Floor Mounted Cabinet Dust Grey

Product Code: MUROPLUS-2DRW500FS-GREY



**SCUDO**  
BEAUTIFUL BATHROOMS

0330 124 7290

sales@scudo.co.uk - www.scudo.co.uk

Scudo is the trading name of Harrison Bathrooms Ltd. Whilst we endeavour to ensure that the product information is accurate we accept no liability for any information given. All images are for illustration purposes only. Product images and specification are subject to change. Measurement are in millimetres and are nominal.

Product Name	MUROPLUS-2DRW500FS-GREY
Product Description	Muro Plus 500 Floor Mounted Cabinet Dust Grey
Product Transportation	
Barcode	5060991251473
Country of origin	China
Commodity code	9403609000
Product Measurements	
Product Weight (KG)	23.00
Product Width (mm)	500
Product Height (mm)	800
Product Depth (mm)	355
Primary Packed Measurements	
Packaged Weight	22.00
Packed Height	455
Packed Width	900
Packed Length	370

General Information	
Construction Material	MFC
Installation type	Wall Mounted
Colour / Finish	Dust Grey

Furniture Attributes	
Supplied Fully Assembled	Yes
Number Of Drawers	2
Number Of Doors	0
Soft Close Doors / Drawers	Yes
Moisture resistant	Yes
Internal Shelves	N/a
Door Opening Width (mm)	N/a
Draw Opening Distance (mm)	220mm
Recommended Concealed Cistern	N/a
False Draws	N/a
Number of False Draws	N/a
Can the door be swapped over to open the opposite way	N/a
Which side is the door hinge located	N/a
Compatible Furniture Part Code	N/a
Compatible Basin Part Code	BASIN-515-365-CER

Handles	
Handle Style	Wrap Over
Handle Finish	Chrome
Handle Material	Stainless Steel
Number of Handles	2

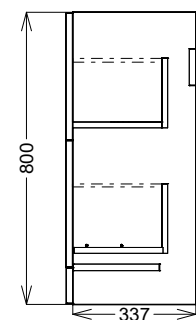
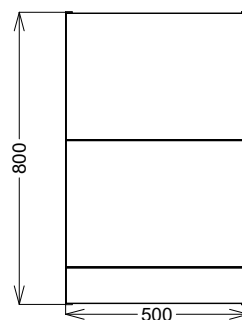
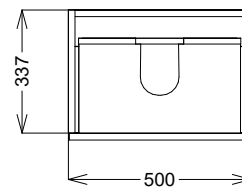

### Dimensions (measurements in mm)



#### LIFETIME GUARANTEE

We are confident in our products and we want our customer to be, we proudly give a lifetime guarantee on our taps and showers, further details can be found on our website